



CEMPS Innovation 1 & SWIOT Building Local Induction

Prepared by:

- Infrastructure and Projects Officer (CEMPS)
- Technical Services Business Partner (CEMPS)

Approved by:

- Director of College Operations (CEMPS)

September 2021

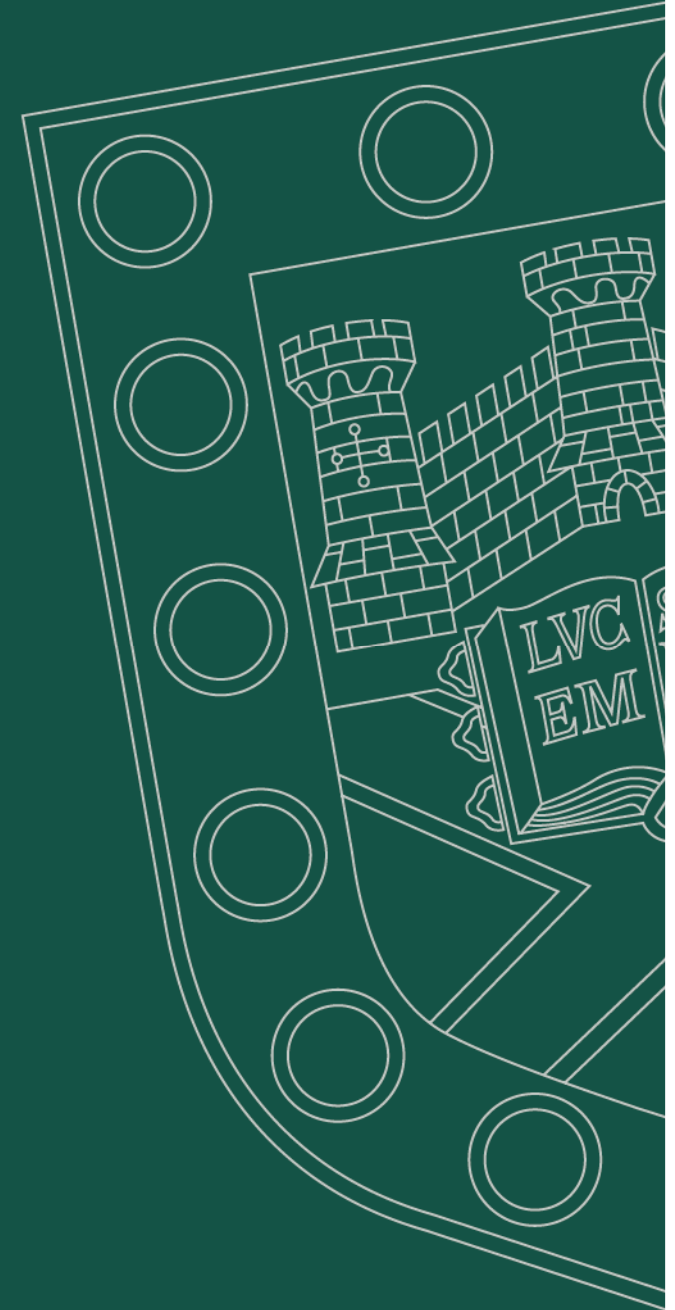

Purpose of this Induction

- Local induction for users of the Innovation 1 & SWIOT buildings
- To ensure staff and PGR students understand and are able to comply with health and safety measures in the building.
- A reminder that compliance is a **personal** responsibility



SafeZone

- UoE highly recommends using the app **SafeZone**
- https://www.exeter.ac.uk/media/universityofexeter/healthandsafety/SafeZone_at_Exeter.pdf
- All staff and students are asked to log into **SafeZone** app when on campus
- Download SafeZone app from the app store
- Set up with your UoE username and read the instructions here:
<https://www.safezoneapp.com/how-it-works>



Building Management

- Measures to support good hand hygiene, with plenty of sanitiser points
- Cleaning stations in teaching spaces and meeting rooms
- Continued enhanced cleaning of shared spaces
- The provision of face coverings and strong encouragement to use these in shared indoor spaces
- Teaching protocols and guidance in place
- Some booking systems will remain in place, some occupancy limits remain in place and will still have occupancy limits on doors, please respect any occupancy limits in place.
- Ventilation guidance in buildings has been taken in to account and there are prompts to open windows where natural ventilation is encouraged
- Strong encouragement to use NHS venue check in QR codes and the NHS contact tracing app to support NHS Test and Trace
- If areas of the building are segregated with barriers and contractor notices this means **no access to this area**. This is done for your own safety.



Working Hours and Building Access

- Innovation and SWIOT will be open 8:00am – 7:00pm Monday to Friday
- Out of hours work is not encouraged but is available through authorised access this will allow working hours from 7am-10pm Monday-Friday and 8am-6pm Saturday-Sunday.
- When working outside of general building opening hours please ensure you are logged on to SafeZone and have completed a lone working risk assessment
- Regular checks will be completed in the building to ensure that only people authorised to do so are in the space. Room occupancy levels will be checked against the agreed occupancy number on the door where applicable



Accessing offices

- Bookable desks for PGRs and Post Docs are available in some shared offices and can be booked via Clustermarket
- Some offices may continue to use local rota systems – this will be made known to office occupants
- If you require swipe card access or keys for a specific area please complete the [CEMPS Building Swipe Access and Key Request Form](#)



Avoiding Movement During Teaching Hours

As this building is a teaching building, it is recommended that you limit your movement in and around the building between 20 past the hour and 20 to the hour e.g. 9:20am-9:40am.

This will be teaching change over times between the hours of 8:20am – 6:40pm, and by avoiding these time periods each hour, you are limiting contact with others in corridors as much as possible



Emergency Actions

Fire and First Aid

- There may be **fewer fire marshals and first aiders in the building, please act responsibly**
- The fire alarm will be tested on Thursdays at 10am
- Otherwise, **if you hear the fire alarm please leave the building**, reminding anyone you see to do the same
- Congregate in the **Car Park**
- You will only be allowed back in the building via the front door when Estate Patrol give the all clear.
- There are first aiders on campus nearby please use SafeZone. Any bystanders to call Estate Patrol 01392 72 3333



Mail and Stores

Mail for building residents will be delivered to the Innovation ground floor kitchen area and will be in the pigeon hole under the initial of your surname.

Your parcels will go to Harrison Stores if instructed, otherwise they will be in LSI Stores. Please book a click and collect slot through [click @ exeter](#) and follow the instructions issued by Stores.



Reporting Problems or Concerns

- If you have **any concern about coming to work** contact your line manager, approach your Head of Discipline, or email empsinfrastructure@exeter.ac.uk
- If you have a **labs query** get in touch with your local technical services support, or Steve Spaul (S.R.Spaul@exeter.ac.uk)
- For all EMPS access requests, including buildings, offices and labs please complete the [CEMPS Building Swipe Access and Key Request Form](#)
- For all enquires about returning to campus or issues with ongoing building projects in EMPS please contact EMPSinfrastructure@exeter.ac.uk
- Any enquiry regarding mailing lists or UDB please contact the Executive Support team emps-est@exeter.ac.uk
- For small maintenance issues e.g. lights flickering, toilets not working, doors not shutting please complete a maintenance request <http://www.exeter.ac.uk/campushelp/forms/maintenance/>
- If you wish to report **an inappropriate incident or behaviour** please contact your line manager or Head of Discipline directly



Do not scale from this drawing.

REVISION	DESCRIPTION	BY	DATE
----------	-------------	----	------

UNIVERSITY OF
EXETER

THIS DRAWING IS COPYRIGHT. A Drawing marked with a © symbol is the property of University of Exeter in whom the copyright vests. Contractors and Consultants must check all dimensions on site. Only figured dimensions are to be used. Any discrepancies to be reported to the Project Manager before work proceed. This drawing shall be used only for the purpose intended.

University of Exeter
Streatham Farm, Prince of Wales Road, Exeter,
Devon. EX4 4PX, United Kingdom.
tel. (+44) 01392 725 533
e-mail: estateservicesadmin@exeter.ac.uk
web: www.exeter.ac.uk

BUILDING NAME INNOVATION CENTRE		BUILDING No BG039	
PROJECT GROUND & FIRST FLOOR			
DRAWING TITLE MASTER DRAWING			
DRAWING No. INN_CEN_GF_FF			REV /
SCALE 1:120 (A1)	DATE 20/07/2020	DRAWN BY KH	APPROVED HW



Building Flow Diagram: SWIoT

Coordinates given off GL intersections

Refer to Slab Setting Out Plans for slab edge/penetration setting out.

Refer to LHC drawing 2500 series drawings for internal blockwork, partition and lining setting out

For all detailed wall types refer to LHC A-1500 series 1:20 Section drawings and 2100 series 1:5 drawings

Wall Types

RW - Retaining Wall (to S.Eng Details)

BE - Bookend Wall - Retaining Wall to S.Eng details with Cement Fibre Cladding above ground

SS - Vertical standing seam cladding on SFS

Rooftight spec. - 20-25-75/170

Refer to structural engineers information for full details of retaining walls, columns and other structural elements

Refer to Landscape Architect design for landscape details

WF - Wildflower Green Roof -

PS - Paved Terrace Area

B - Ballast

Refer to Xypex spec for details on waterproofing

All movement joints set-out by S.Eng - see S.Eng drawings and specification.

PV Array indicative - see Electrical Engineer drawings for quantity and setting out

RWO - Rainwater Outlets and RVPs - 90-10-20/306

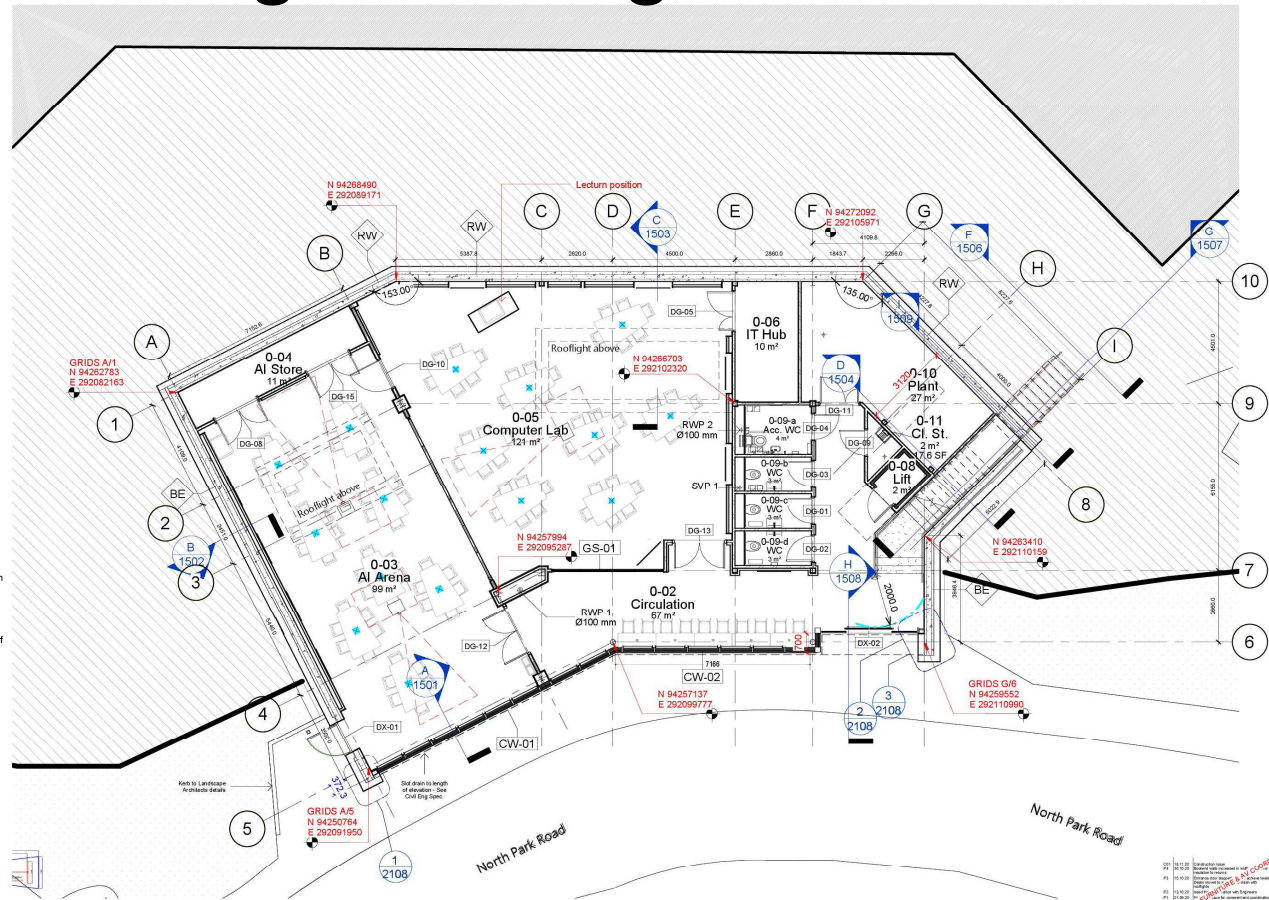

Scale 1:100

REVISIONS			
NO.	DATE	DESCRIPTION	BY
01	11/05/18	Issue for Furniture & AV Coordination	lhc
02	11/05/18	Issue for Furniture & AV Coordination	lhc
03	11/05/18	Issue for Furniture & AV Coordination	lhc
04	11/05/18	Issue for Furniture & AV Coordination	lhc
05	11/05/18	Issue for Furniture & AV Coordination	lhc
06	11/05/18	Issue for Furniture & AV Coordination	lhc
07	11/05/18	Issue for Furniture & AV Coordination	lhc
08	11/05/18	Issue for Furniture & AV Coordination	lhc
09	11/05/18	Issue for Furniture & AV Coordination	lhc
10	11/05/18	Issue for Furniture & AV Coordination	lhc

lhc design

lhc design